

Model: BDGB-300/400
3-Axis Pinion
 HUNTING GROUND BLIND

WARNING

- ALWAYS READ/UNDERSTAND ALL INSTRUCTIONS/WARNINGS PRIOR TO EACH USE.



Please inspect the shipping carton for evidence of damage or that it may have been opened before you received it. Then inspect your product carefully. Compare it to the image on the product label and the picture illustration in your instructions. If for any reason you are not satisfied with the product, do not use it until the problem is solved or corrected.

Pinion Joint

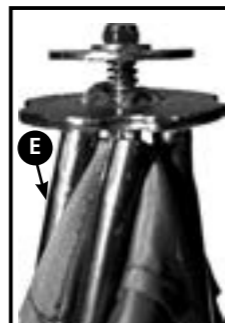

Box Content:	TSGB-300 /400
A 1 Hub Blind	Part #HB-300 /HB-400
B 8 Ground Stakes	Part #GS-100 /GS-100
C 4 Ground Stake Ropes	Part #GSR-125 /GSR-125
D 1 Carrying Case	Part #CC-100 /CC-400
E 20 Fiber Poles	Part #FP-300 /FP-400
F 12 Shoot Through Mesh	Part #STM-300 /STM-400

Note: Product fabric, zippers or toggle loops/clasps are NOT warranted.

PRODUCT TIPS & WARNINGS:

- DO NOT over-tighten the pinion locknut .
- Side Panels are under pressure. DO NOT put your head or face near pinion joint at any time.
- ALWAYS take your time when setting or taking down this blind. NEVER force the blind!!! Forcing this product will rip the fabric ,break poles.
- Meets CPAI-84 fire retardent requirements. This product is NOT fireproof!!! NEVER use any type heater/heat source inside or around this blind!!
- ALWAYS stake this blind to the ground every time this product is used.
- Always check with your state or local Conservation for rules /regulations for using ground blinds in your area.
- DO NOT leave the ground blind in direct sunlight. UV rays will fade & damage the fabric.
- ALWAYS air out your blind for two-three days before prior to each use. This will help with scent reduction. Insure all windows are open.

SET-UP INSTRUCTIONS: ALWAYS TAKE YOUR TIME!! NEVER FORCE THIS BLIND OPEN OR CLOSED!!

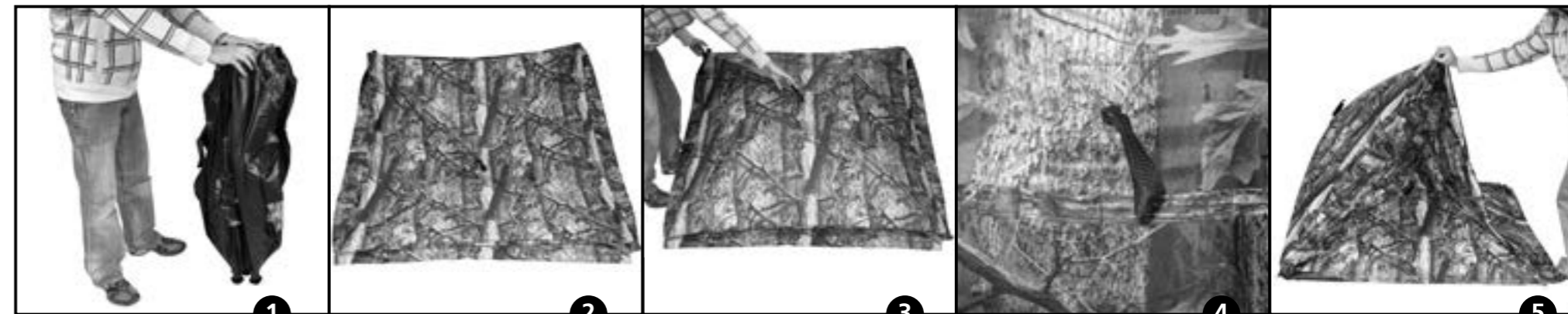

Remove the tent from the carrying case. Stand the tent up so that the pinion joints are on the ground. Hold the tent together. Un-Clip the strap that holds the tent together. ALWAYS inspect the pinion locknuts to insure that 1-2 threads are showing. DO NOT over-tighten the locknuts where the spring is depressed.

Release the side and allow the tent to lay flat as possible. The top non-window section should be facing UP. NOTE: The pinions will not allow the sides to lay flat on the floor. INSURE ALL WINDOWS ARE ZIPPED CLOSED!! This includes the door opening!!

After locating the Top Panel, be extremely careful, and pull up on the roof section FIRST. Use the pull handle strap located in the center of the top panel. IMPORTANT: Always open the Top or Roof panel FIRST!!

This illustration shows the pull strap handle to open the top and side panels. Always use the pull strap handle to open and close this blind. Careful, side and top are under pressure.

Place your foot on one bottom corner of the tent and push UP on the roof corner with your foot holding the bottom down. This will open up the side poles so the side can be opened.



Keeping your hand on the corner, reach with your opposite hand and pull out on the side panel.

Proceed to the next side. Place your foot onto the bottom corner and push the roof corner up. This will open up the inside poles.

Pull outward from the center strap until the side panel comes open. Repeat fro the remaining two other sides.

Now, the tent is assembled. NEVER force the side panels open. Forcing the panels open will cause the poles or end cap to break. Place the ground blind in the area you picked out and stake it to the ground securely. Staking to the ground will prevent movement of the blind when getting in and out of the blind.

This is a image of the inside view of the side panel. Insure the tent is opened correctly where the sides and roof are tight. Shoot-Through mesh attached from inside.

TAKE-DOWN INSTRUCTIONS: ALWAYS TAKE YOUR TIME! NEVER FORCE THE BLIND CLOSED.

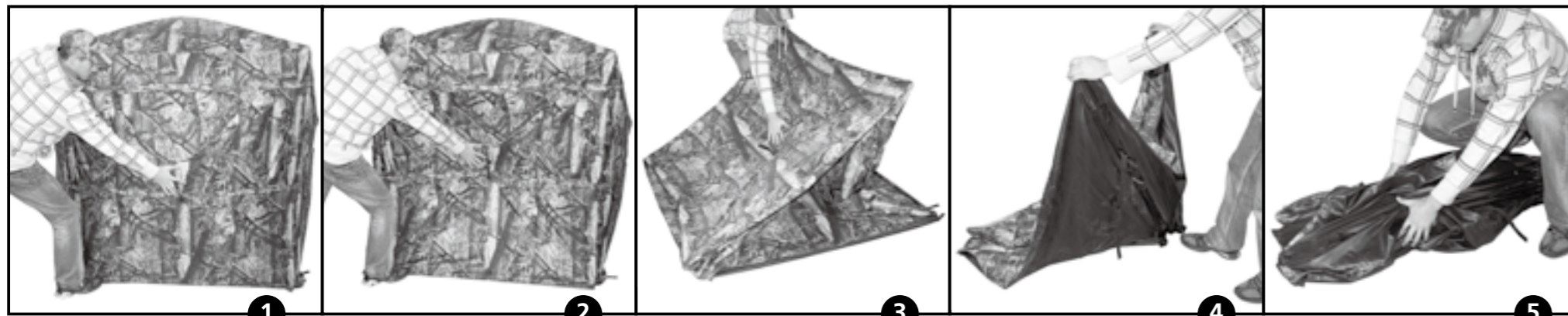

1
CLOSE ALL windows and the door opening!! Remove all ground stakes and brush that was used to conceal the blind. In a open area, starting with any side, push the side IN. Insure the blind all folds into the center. Take your time in taking down this blind!!

2
Walk around to the next side and push IN on the next side. Insure that the 2nd side goes inward toward the first one. Repeat until all sides are collapsed inward. All the sides should meet in the center and the roof or top should still be up.

3
Push down on the top section where the side will want to roll or come inward. Take your time when taking down this blind. Don't force the blind closed

4
Being extremely carefull, walk on opposite side so that you can see the pinion joints. Carefull on moving the side corners over. DO NOT force ths corners down. The pinion joints may become twisted or bound, adjustment of the corner may be need by picking up on the corner and laying it down on the opposite corner.

5
The tent you look like above image when folded down.

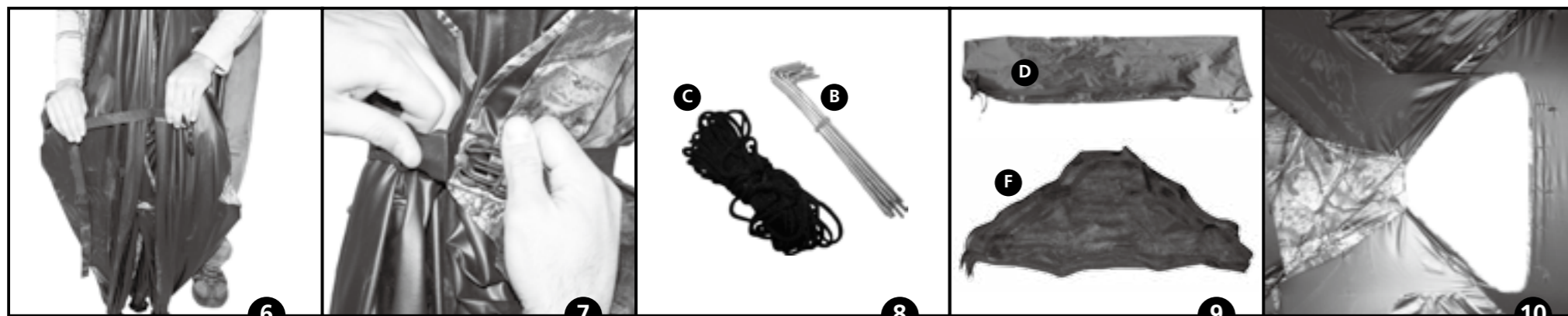

6
Squeeze from the outside to bring the fabric together.

7
Clip the strap located opposite of the pinion end to hold the fabric together to help aide getting the tent back into the carrying case. Slide the tent back into the bag and zip close. Insure the tent is not damp or wet.

8
Ground Stakes and Ropes shown. (1) Ground Stake for each corner and (1) Ground Stake with (1) Ground Stake Rope (tied off to the center pull handle) on each side MUST be used after the ground blind has been set-up.

9
Carrying Case and Shoot Through Mesh

10
This image shows the window open. Note: Zippers are not used on any of the windows. Toggle clasps hold the window closed. Do not over-stretch the pre-sewn loops or toggles, they will break if over-stretched. Toggles and loops are not warranted.

SAFETY WARNINGS & PRODUCT TIPS

Please Read/Understand/Practice with/Follow ALL Instructions and Safety Warnings prior to each use!!!

- ALWAYS insure that ALL windows and the door opening is zipped CLOSED before putting up or taking down this ground blind!!!
- Insure the muzzle or barrel of your firearm is completely outside the window opening. Know your target and what is behind it. Check your local conservation for blaze orange requirements before using any ground blind in the field.
- THIS IS NOT A CHILDREN TO OR PLAY AREA. This product is intended to used by adults of 18 years of age and older for hunting purposes only!! ALWAYS keep out of reach of children. ALWAYS PRACTICE WITH THIS BLIND FOR SAFE USE PRIOR TO USING IN THE FIELD.
- NEVER shoot a firearm threw the shoot-through mesh or material fabric. The muzzle/barrel flash/sparks will cause the mesh/fabric to melt or burn. Insure the muzzle/barrel of the gun is completely OUTSIDE the window opening!! TIP: Know your target and what is behind it. Check local conservation for blaze orange requirements before using firearms with any ground blind. Safety First!!
- NEVER shoot mechanical broad-heads through the shoot-through mesh. The mesh will cause the broad-heads to deploy. Use fixed blade broad-heads ONLY. TIP: Know your target and what is behind it. Reminder: The arrow is below your sights. Safety First!!
- ALWAYS check the axis pinion locknut to insure that 1-2 threads are through the nylon material. DO NOT over-tighten the locknut.
- ALWAYS keep your head/face AWAY from the pinion joint when setting-up or taking down this product. Pinion is under pressure.
- Stake down the ground blind during each use. ALWAYS remove ground stakes before taking down the blind.
- Tip: Use the brush strips on the tent to conceal your blind into the environment or area you have selected. Use small light branches.
- Store in a cool dry place away from any heat sources or electrical outlets. NEVER store/pack-away any blind that is wet or damp.
- Always air out the blind with the windows open for two or three days prior to each use. This will help with scent reduction.
- Always check with your state & local Conservation (DNR) for rules/regulations BEFORE using this ground blind in the field.
- Always avoid leaving or setting up the blind in direct sunlight. The sunlight will fade the fabric over a period of time.
- THIS IS NOT A CHILDREN TOY OR PLAY AREA. NEVER allow child/children to play inside or around this ground blind for any reason. ALWAYS have constant adult supervision when a child/children is using this product. ALWAYS keep out of reach of children.
- DO not use any ground blind during any adverse conditions that may produce strong winds, rain, snow, sleet, or lightening.
- NEVER allow any material to cover your face, nose, or mouth which could/can cause or lead to suffocation or death.
- NEVER USE heater(s), smoke, matches, lighters, lanterns, sleep, burning any combustibile material, stoves, grills, heat sources, electrical outlets, electrical equipment that use a power source, candles, open flames, INSIDE/NEAR/AROUND/OR BY ANY GROUND BLIND FOR ANY REASON AT ANY TIME. Heaters/Fire can cause carbon-monoxide poisoning.
- NEVER store or use any flammable or combustibile materials inside,near, or around any ground blind.
- NEVER use/re-fuel any combustibile container, fuel burning product, or any type of motor vehicle inside/near/around this product.
- NEVER leave any ground blind near or around any open fire/campfires. Sparks from any fire can cause the tent to burn/melt or catch fire. ALWAYS store/use in a secure location free of any heat sources or open/contained fires.
- This blind meets the CPAI-84 flammability requirements. The material in this blind is made up of fire retardant material. This blind is NOT FIREPROOF!!! This blind will burn, melt, or catch fire if left in direct contact with a open flame or heat source for any period of time. Application of any foreign substance to the fabric may render the fire retardant material inactive. Failure to adhere to this warning can result in serious bodily injury or death.
- TIP: If the zipper is tight to zip open or closed, push the side panel in and zip open or closed. This relieves the pressure on zipper and side fabric.